

ROCKWOOL® and Grodan® are registered trademarks of the ROCKWOOL Group.

Model number:  
GS21CL12  
GS21CL13



### ROCKWOOL BV / Grodan

Industrieweg 15  
6065 JG ROERMOND  
Postbus 1160  
6040 KD ROERMOND  
the Netherlands

T +31 (0)475 35 30 20  
F +31 (0)475 35 37 16  
info@grodan.com  
www.grodan.com



Info about certification

FCC: Section 15.19 a  
This device complies with part 15 of the FCC Rules. Operation is subject to the following two conditions: (1) This device may not cause harmful interference, and (2) this device must accept any interference received, including interference that may cause undesired operation.

The substrates from Grodan are the only stone wool growing media awarded an EU Ecolabel.



EU Ecolabel: NL/048/001



## Climate sensor user manual



Part of the ROCKWOOL Group

ONLY AVAILABLE FOR  
UK, EUROPE, UNITED STATES  
CANADA, NEW ZEALAND, AUSTRALIA

1

**Make sure your GroSens Gateway is online before you start setting up your GroSens sensors!**

Find all your manuals online:  
[www.support.grodan.com/manuals](http://www.support.grodan.com/manuals)



2

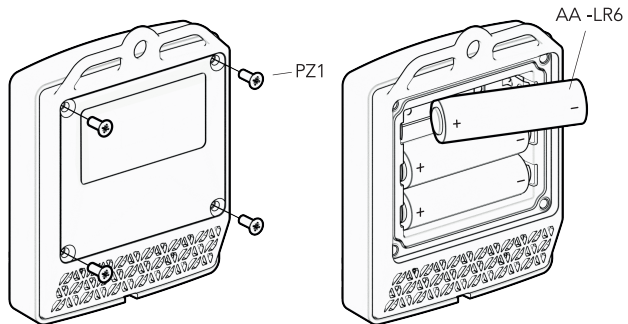

3

